

4100E Series 2 Electronic Siren



◇ *Up to 122db@1m*

◇ *Great IP weather rating*

◇ *Single tone installed at manufacture*

◇ *Wide Cone speaker for sound projection*

Key Features

- ◇ **Sound Output** Wide Cone Speaker Continuous Rating upto 122 decibel@1m
- ◇ **IP Weather Rating** UV protected weatherproof control box IP67 & IP65 Speaker
- ◇ **Voltages available** 240vac 110vac 24vdc 12vdc
- ◇ **Origin:** Circuit board designed & assembled In Australia.
- ◇ **Volume** Internal volume Control
- ◇ **Popular Tones** Low Trumpet tone, Twin Trumpet Tone & Australian Evacuation AS2220.

Features

Sirens control box is assembled and tested in Australia.

Control box UV protected weatherproof to IP67 & IP65 Wide cone Speaker.

Speaker is IP65 and is a quality aluminium wide cone with Stainless steel mounting bracket.

Australian Evacuation AS2220 Tone & Australian Alert Siren.

Low Trumpet tone, Twin Trumpet tone & Official AFL tone.

Selectatone 4150W Tones, High Pulsing Air Raid & Low Pulsing Air Raid.

Speaker cable can be extended by your Electrician up to 20m for ease of access.

Replacement for Electromechanical RVB 4100CT and RVB 4100 Scroll & Selectatone Sirens.

Applications

Trumpet tones are unique, ideal for Industrial applications such as Machines Safety Alerts & Alarms.

Suitable for use Outdoor such as Processing Plants Warehouses Mining Cranes Machinery where evacuation or a distinctly different trumpet hooter tone siren is needed.

Ideal for various Sporting Ovals and Sports Clubs requiring Timekeeping, Start of Game race starters for Football and Yacht races.

Technical Specifications

| | |
|---------------------------|--|
| Name | 4100E Series 2 Electronic Siren |
| Voltages | 240vac 110vac 24vdc 12vdc |
| Sound Output | Continuous Rating upto 122 decibel@1m (12vdc up to 120db@1m) |
| Load @ Full Volume | 240vac -0.12 Amps 110vac-0.2 Amps 24vdc -0.9 Amps 12vdc - 0.8 Amps |
| Load @ Start Up | All voltages Less than 0.5 Amps |
| Cable Entry | Cable Entry—CG16 cable gland IP68 |
| Construction | Horn: Aluminum powder coated ABS Resin Reflector rear cover. Bracket, screws and bolts Stainless steel. Control Box – Opaque ABS/PC base and lid. UV Resistant. |
| Dimensions | 240vac 110vac Control Box 170Hx140Wx95D mm 24vdc 12vdc Control Box 125Hx125Wx75D mm Speaker 285W × 227H ×277D mm |
| Weight | 3kg & (12vdc 2.4kg) |
| Models up to 122db | 4100E-S2 Low Trumpet tone siren 4100E-S2 Twin Trumpet tone siren 4100E-S2 AFL tone siren 4100E-S2 Aust Evac AS2220 Tone siren |
| Models up to 120db | 4100E-S2 Aust Alert Tone siren 4100E-S2 Low Pulsing Air Raid Tone siren 4100E-S2 High Pulsing Air Raid Tone siren 4100E-S2 Aust Alert Tone siren 4100E-S2 Selectatone sounds include: Siren Wail, Pulsing, Siren Slow & Fast. |

4100E Series 2 dimensions

■ APPEARANCE

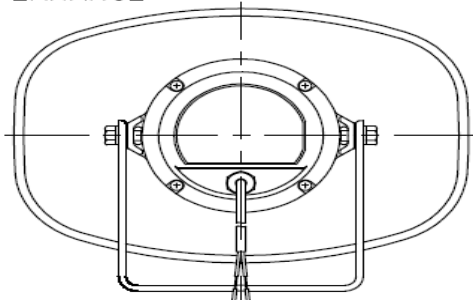

Rear View

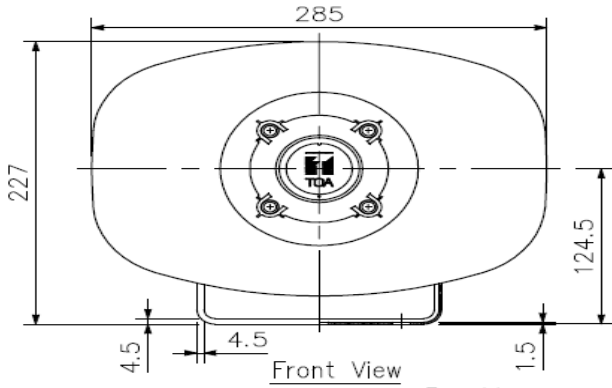

Front View

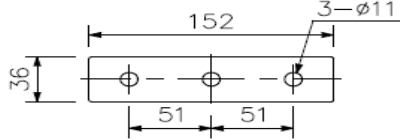

Bracket dimensional diagram

UNIT:mm SCALE:1/5

Speaker 30w 8ohm dimensions

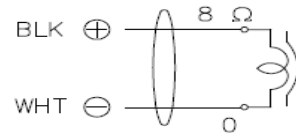

Wiring diagram

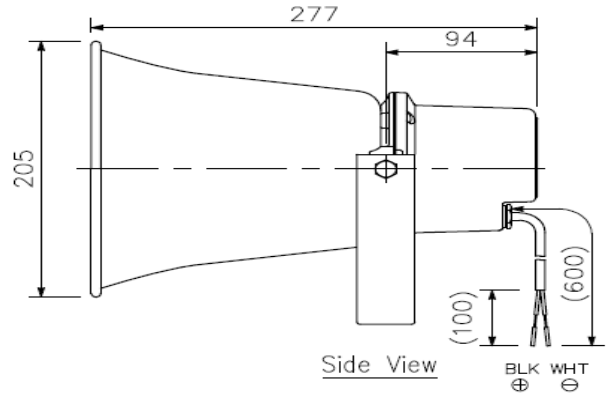

Side View

Note: Numerical values in parentheses are for reference only.

240vac an 110vac Control box dimensions

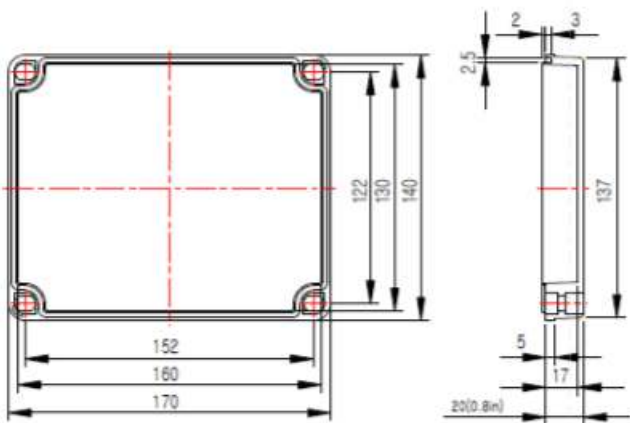

12vdc and 24vdc Control Box dimensions

