

# Long Range Warning Sirens

## 10S Motorised Siren 140 decibel@1m



- Range up to 10000m\*
- 3ph motor driven siren
- Robust cast aluminium
- Sound output 140dB @ 1m
- Weatherproof

Voltage	Running Current	Starting Current
415VAC 50Hz 3ph $\pm 5\%$	7.4A	62A

\*Range based on sound level of 60dB at quoted distance, in still air at 20°C, with the siren mounted at 5m above ground level and without obstructions.

### Specifications:

Sound output: 140dB @ 1m  
 Sound frequency: 560Hz  
 Motor power: 4kw  
 Protection: IP55  
 Rating: Continuous  
 Cable entry: 2 x M32  
 Construction: Cast aluminium siren head, aluminium alloy motor, steel base  
 Weight: 68Kg

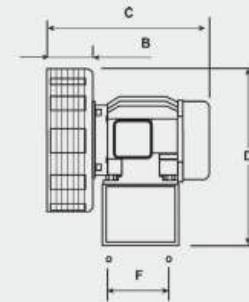
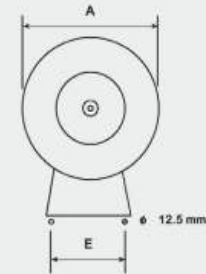

Dimensions in mm

## 15D Motorised Siren 145 decibel@1m



- Range up to 15000m\*
- Motor driven siren available three phase motor
- Sound output 145dB @ 1m
- Low penetrating tone
- Weatherproof

Voltage	Running Current	Starting Current
415Vac 3ph 50Hz $\pm 5\%$	13.4A	105A

\*Range based on sound level of 60dB at quoted distance, in still air at 20°C, with the siren mounted at 5m above ground level and without obstructions

### Specifications:

Sound output: 145dB @ 1m  
 Sound frequency: 480/560Hz  
 Motor power: 7.5kw  
 Protection: IP55  
 Rating: 10m on/5m off  
 Cable entry: 1 x M32  
 Construction: Cast aluminium siren head, cast iron motor  
 Weight: 118Kg

